

Rhan A/ Part A
Fformat trwydded mangre/ Format of premises licence

Rhif trwydded mangre
Premises licence number

PRM070

Rhan A1 – Manylion y Fangre/ Part A1 – Premises Details

Cyfeiriad post y fangre neu, os nad oes, gyfeirnod map arolwg ordnans neu ddisgrifiad
Postal address of premises or, if none, ordnance survey map reference or description

Pelham Hall
Moorcroft Road
Penallt

Tref bost/ Post town	Monmouth	Cod post/ Post code	NP25 4AH
---------------------------------	----------	--------------------------------	----------

**Rhif ffôn/
Telephone number**

Lle mae cyfyngiad amser ar y drwydded, y dyddiadau
Where the licence is time limited the dates

Dyddiad Cyhoeddi/ Issue Date: 04/03/2016

Gweithgareddau y mae angen trwydded ar eu cyfer a awdurdodir gan y drwydded
Licensable activities authorised by the licence

Plays; Films; Live Music; Recorded Music; Performances of Dance; Supply of Alcohol, fel y nodir gydag ymyl goch ar y cynllun a atodir gyda'r drwydded/ as indicated edged red on the plan attached to this licence.

Yr amserau y mae'r drwydded hon yn awdurdodi cynnal gweithgareddau y mae angen trwydded ar eu cyfer

The times the licence authorises the carrying out of licensable activities

Plays*
Monday: 09.00 - 00.30
Tuesday: 09.00 - 00.30
Wednesday: 09.00 - 00.30
Thursday: 09.00 - 00.30
Friday: 09.00 - 00.30
Saturday: 09.00 - 00.30
Sunday: 09.00 - 00.30

*A licence is not required for performance of a play providing it takes place between 08.00hrs-23.00hrs and the audience do not exceed 500 persons.

Films
Monday: 09.00 - 00.30
Tuesday: 09.00 - 00.30

Wednesday:09.00 - 00.30
Thursday:09.00 - 00.30
Friday:09.00 - 00.30
Saturday:09.00 - 00.30
Sunday:09.00 - 00.30

Live Music**

Monday:09.00 - 00.30
Tuesday:09.00 - 00.30
Wednesday:09.00 - 00.30
Thursday:09.00 - 00.30
Friday:09.00 - 00.30
Saturday:09.00 - 00.30
Sunday:09.00 - 00.30

**A licence is not required for live music within the on-licence premises providing it takes place between 08.00hrs - 23.00hrs and the audience do not exceed 500 persons.

Recorded Music***

Monday:09.00 - 00.30
Tuesday:09.00 - 00.30
Wednesday:09.00 - 00.30
Thursday:09.00 - 00.30
Friday:09.00 - 00.30
Saturday:09.00 - 00.30
Sunday:09.00 - 00.30

***A licence is not required for recorded music within the on-licence premises providing it takes place between 08.00hrs - 23.00hrs and the audience do not exceed 500 persons.

Performance of Dance****

Monday:09.00 - 00.30
Tuesday:09.00 - 00.30
Wednesday:09.00 - 00.30
Thursday:09.00 - 00.30
Friday:09.00 - 00.30
Saturday:09.00 - 00.30
Sunday:09.00 - 00.30

****A licence is not required for performance of dance providing it takes place between 08.00hrs-23.00hrs and the audience do not exceed 500 persons.

Supply of Alcohol

Monday:09.00 - 0.30
Tuesday:09.00 - 00.30
Wednesday:09.00 - 00.30
Thursday:09.00 - 00.30
Friday:09.00 - 00.30
Saturday:09.00 - 00.30
Sunday:09.00 - 00.30

Oriau agor y fangre

The opening hours of the premises

Opening Hours

Monday:09.00 - 01.00
Tuesday:09.00 - 01.00
Wednesday:09.00 - 01.00
Thursday:09.00 - 01.00
Friday:09.00 - 01.00
Saturday:09.00 - 01.00
Sunday:09.00 - 01.00

Lle mae'r drwydded yn awdurdodi cyflenwadau alcohol, a yw'r rhain yn gyflenwadau yn y fangre a/neu i ffwrdd o'r fangre

Where the licence authorises supplies of alcohol whether these are on and/or off supplies

Alcohol-On the premises

Alcohol-Off the premises

Rhan 2/ Part 2

Enw, cyfeiriad (cofrestredig), rhif ffôn ac e-bost (lle'n berthnasol) deiliad trwydded mangre

Name, (registered) address, telephone number and email (where relevant) of holder of premises licence

Pelham Hall Management Committee

Pelham Hall

Moorcroft Road

Penallt

Monmouth

NP25 4AH

Rhif cofrestredig y deiliad, er enghraifft rif cwmni, rhif elusen (lle'n berthnasol)

Registered number of holder, for example company number, charity number (where applicable)

Registered Charity 524369

Enw goruchwyliwr mangre ddynodedig lle mae trwydded y fangre yn awdurdodi cyflenwi alcohol / Name of designated premises supervisor where the premises licence authorises for the supply of alcohol: Not Applicable – Dissapplication of Mandatory Condition issued 04/03/2016

Atodiad 1 - Amodau gorfodol

Annex 1 – Mandatory conditions

The Alternative Licence Condition in respect of the supply of alcohol from community premises

1. The Supply of alcohol under the premises licence must be made or authorised by the management committee.

Mandatory Conditions – Security Activity

2. Where at specified times one or more individuals may be at the premises to carry out a security activity, each individual must be licensed by the Security Industry Authority.

For the purposes of this section:

i) "security activity" means an activity to which paragraph 2(1)(a) of that Schedule applies; and

ii) paragraph 8(5) of that Schedule (interpretation of references to an occasion) applies as it applies in relation to paragraph 8 of that Schedule.

Mandatory Conditions – Exhibition of a Film

3. The admission of children to the exhibition of any film must be restricted in accordance with any recommendation made by the British Board of Film Classification (BBFC) or in the absence of a recommendation from the BBFC, the Licensing Authority.

For the purposes of this section:

i) "children" means persons aged under 18 years of age.

Mandatory Conditions – Supply of Alcohol for Consumption On The Premises

4. The responsible person shall take all reasonable steps to ensure that staff on relevant premises do not carry out, arrange or participate in any irresponsible promotions in relation to the premises.

In this paragraph, an irresponsible promotion means any one or more of the following activities, or substantially similar activities, carried on for the purpose of encouraging the sale or supply of alcohol for consumption on the premises—

a) games or other activities which require or encourage, or are designed to require or encourage, individuals to—

(i) drink a quantity of alcohol within a time limit (other than to drink alcohol sold or supplied on the premises before the cessation of the period in which the responsible person is authorised to sell or supply alcohol), or

(ii) drink as much alcohol as possible (whether within a time limit or otherwise);

(b) provision of unlimited or unspecified quantities of alcohol free or for a fixed or discounted fee to the public or to a group defined

by a particular characteristic in a manner which carries a significant risk of undermining a licensing objective; .

(c) provision of free or discounted alcohol or any other thing as a prize to encourage or reward the purchase and consumption of alcohol over a period of 24 hours or less in a manner which carries a significant risk of undermining a licensing objective; .

(d) selling or supplying alcohol in association with promotional posters or flyers on, or in the vicinity of, the premises which can reasonably be considered to condone, encourage or glamorise anti-social behaviour or to refer to the effects of drunkenness in any favourable manner; .

(e) dispensing alcohol directly by one person into the mouth of another (other than where that other person is unable to drink without assistance by reason of disability).

5. The responsible person must ensure that free potable water is provided on request to customers where it is reasonably available.

6. (1) The premises licence holder or club premises certificate holder must ensure that an age verification policy is adopted in respect of the premises in relation to the sale or supply of alcohol.

(2) The designated premises supervisor in relation to the premises licence must ensure that the supply of alcohol at the premises is carried on in accordance with the age verification policy.

(3) The policy must require individuals who appear to the responsible person to be under 18 years of age (or such older age as may be specified in the policy) to produce on request, before being served alcohol, identification bearing their photograph, date of birth and either—

- (a) a holographic mark, or
- (b) an ultraviolet feature.

7. The responsible person must ensure that—

(a) where any of the following alcoholic drinks is sold or supplied for consumption on the premises (other than alcoholic drinks sold or supplied having been made up in advance ready for sale or supply in a securely closed container) it is available to customers in the following measures—

- (i) beer or cider: ½ pint;
- (ii) gin, rum, vodka or whisky: 25 ml or 35 ml; and
- (iii) still wine in a glass: 125 ml;.

(b) these measures are displayed in a menu, price list or other printed material which is available to customers on the premises; and
(c) where a customer does not in relation to a sale of alcohol specify the quantity of alcohol to be sold, the customer is made aware that these measures are available.”

Mandatory conditions - The ban of the sale of alcohol below the cost of duty plus VAT

8. (1) A relevant person shall ensure that no alcohol is sold or supplied for consumption on or off the premises for a price which is less than the permitted price.

(2) In this condition:-

(a) "permitted price" is the price found by applying the formula $P = D + (D \times V)$, where-

(i) P is the permitted price,

(ii) D is the amount of duty chargeable in relation to the alcohol as if the duty were charged on the date of the sale or supply of the alcohol, and

(iii) V is the rate of value added tax chargeable in relation to the alcohol as if the value added tax were charged on the date of the sale or supply of the alcohol;

(b) "duty" is to be construed in accordance with the Alcoholic Liquor Duties Act 1979;

(c) "relevant person" means, in relation to premises in respect of which there is in force a premises licence-

(i) the holder of the premises licence,

(ii) the designated premises supervisor (if any) in respect of such a licence, or

(iii) the personal licence holder who makes or authorises a supply of alcohol under such a licence;

(d) "relevant person" means, in relation to premises in respect of which there is in force a club premises certificate, any member or officer of the club present on the premises in a capacity which enables the member or officer to prevent the supply in question; and

(e) "value added tax" means value added tax charged in accordance with the Value Added Tax Act 1994.

(3) Where the permitted price would not be a whole number of pennies, the permitted price shall be taken to be the price rounded up to the nearest penny.

(4) Where the permitted price on a day ("the first day") would be different from the permitted price on the next day ("the second day") as a result of a change to the rate of duty or value added tax, the permitted price which would apply on the first day applies to sales or supplies of alcohol which take place before the expiry of the period of 14 days beginning on the second day.

Atodiad 2 – Amodau sy'n cydymffurfio gyda'r Atodlen Weithredu Annex 2 – Conditions consistent with the Operating Schedule

Prevention of Crime and Disorder

1. The Licensee shall in all things conduct the premises in a decent, sober and orderly manner, and take whatever steps are necessary to ensure that there is no profanity, impropriety of language, dress, dance or gesture which is in any way offensive to public feelings or is likely to cause a breach of the peace. Committee Members in attendance during Hall functions.

Public Safety

2. Duly authorised officers of the Council, Police Constables and duly authorised officers of the South Wales Fire and Rescue Service shall at all reasonable times have free ingress to the licensed premises and the Licensee or the person in charge in the absence of the Licensee shall comply with any reasonable safety measure that may be required of him by any duly authorised officer of the Council.

3. Lighting, Electrical Fittings etc.

(a) All electrical fittings, wiring and appliances shall be constructed and maintained in a safe and satisfactory condition and to the satisfaction of the Council and whensoever required to do so by the Council the licensee shall submit to the Council a certificate given by a qualified Electrical Engineer that the electrical installations have been examined and tested and are in a safe working condition.

(b) All electric lamp holders within reach of the public shall be kept fitted with lamps or otherwise protected.

(c) The Licensee shall ensure that socket outlets for use with temporary or portable Electrical Equipment on or in the vicinity of any stage area, and any circuits associated with spotlights or other stage equipment, shall be protected by one or more "Residual Current Devices" as necessary, having an adequate load current, rating and a 30 mA Tripping current.

4. Fire, Etc.

(a) Except with the permission of the Council in writing, and in accordance with any conditions attached to such permissions, scenery or stage properties shall not be kept or used on the platform or in any other part of the premises.

(b) Except with the consent of the Council in writing and subject to any conditions, which may be attached to such permission, explosives or highly inflammable substances shall not be brought in or used on the premises.

(c) Toy balloons filled with inflammable gas shall not be used, sold or exhibited on the premises.

(d) Limelight acetylene gas installations or steel cylinders for the storage of compressed air, oxygen, hydrogen or other liquid gas under pressure shall not be used except with the permission of the

Council.

(e)The Licensee and the staff of attendants shall take due precautions for the prevention of accidents.

(f)Any outbreak of fire, however small, shall be reported immediately to the Fire Brigade.

(g)All areas of the premises so designated by the Council, shall comply with Class O and Class I, as contained in the Building Regulations.

5. Other Safety Matters

(a)All drugget, matting and other floor coverings shall be secured and maintained so that they will not be likely to ruck or to be in any way a source of danger.

6. Conditions of Premises; Heating, Ventilations; Lavatories.

(a)All parts of the premises and fittings therein, including the seating, door fastenings and notices, shall be maintained at all times in good order and condition.

7. Heating and Ventilation

(a)The public parts of the premises shall be kept properly and sufficiently ventilated and heated to the satisfaction of the Council.

(b)Every heating appliance used in the premises, which is so situated as to be within reach by any member of the public shall be fitted with guards to comply to standards of construction and fitting, required by the Heating Appliances (Fire Guard) Regulations 1953 or any amendment thereto in the case of heating appliances of a type which are so designed that they are suitable for use in residential premises.

(c)Without the consent of the Council in writing no portable heaters shall be used on the premises.

(d)Every heating appliance situated in part of the premises to which the public are admitted shall be fixed in position.

(e)The several lavatories, W.C.'s and urinals in the licensed premises shall at all times be kept in good order and repair, and be properly and effectually cleansed, ventilated, disinfected and supplied with water, and the doors leading thereto shall be suitably marked.

(f)The Licensee shall provide and maintain in a suitable position such number of sanitary conveniences for use of persons frequenting the premises, as the Council consider reasonable.

8. Adequate and appropriate first aid equipment and materials are available on the premises.

Prevention of Public Nuisance

9. Prominent, clear and legible notices are displayed at all exits requesting patrons to respect the needs of local residents and to leave the premises and the area quietly.

Protection of Children

10. Children under 16yrs will only be allowed in the bar area when accompanied by a parent/guardian or adult acting in loco parentis.
11. Adults should have a satisfactory Disclosure and Barring Check if attending and supervising events involving working with children.
12. The premises has a 'proof of age' policy (Challenge 21) and staff will be trained on this policy.
13. Anyone hiring the Hall will sign a document signifying that they agree by the conditions of the licence, especially those regarding working with children.

Atodiad 3 – Amodau a osodir ar ôl gwrandawriad gan yr awdurdod trwyddedu
Annex 3 – Conditions attached after a hearing by the licensing authority

Not Applicable

Atodiad 4 – Cynlluniau
Annex 4 – Plans

Licensed area - ground floor



Licensed area – first floor

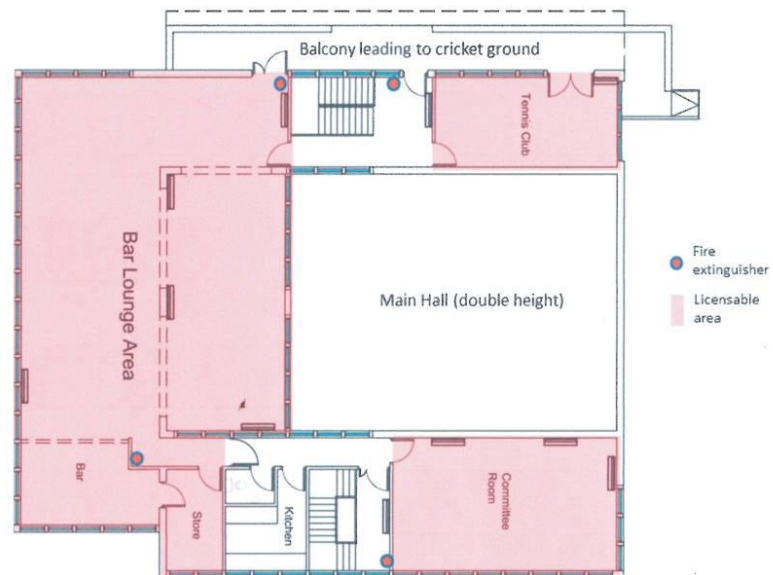

NB the building is on a slope such that the balcony of the first floor is also at ground level, thus providing alternative entrances/exits to the Hall and also disabled access to the first floor.

Rhan B/ Part B
Crynodeb trwydded mangre/ Premises licence summary

Rhif trwydded mangre
Premises licence number

PRM070

Rhan A1 – Manylion y Fangre/ Part A1 – Premises Details

Cyfeiriad post y fangre neu, os nad oes, cyfeirnod map arolwg ordnans neu ddisgrifiad Postal address of premises or, if none, ordnance survey map reference or description	
Pelham Hall Moorcroft Road Penallt	
Tref bost/ Post town Monmouth	Cod post/ Post code NP25 4AH
Rhif ffôn/ Telephone number	
Lle mae cyfyngiad amser ar y drwydded, y dyddiadau / Where the licence is time limited the dates: Dyddiad Cyhoeddi/ Issue Date: 04/03/2016	
Gweithgareddau y mae angen trwydded ar eu cyfer a awdurdodir gan y drwydded / Licensable activities authorised by the licence: Plays;Films;Live Music;Recorded Music;Performances of Dance;Supply of Alcohol, fel y nodir gydag ymyl goch ar y cynllun a atodir gyda'r drwydded/ as indicated edged red on the plan attached to this licence.	
Yr amserau y mae'r drwydded yn awdurdodi cynnal gweithgareddau y mae angen trwydded ar eu cyfer / The times the licence authorises the carrying out of licensable activities Plays*, Live Music**, Recorded Music***, Performance of Dance**** Monday-Sunday:09.00 - 00.30 *A licence is not required for performance of a play providing it takes place between 08.00hrs-23.00hrs and the audience do not exceed 500 persons. **A licence is not required for live music within the on-licence premises providing it takes place between 08.00hrs - 23.00hrs and the audience do not exceed 500 persons. ***A licence is not required for recorded music within the on-licence premises providing it takes place between 08.00hrs - 23.00hrs and the audience do not exceed 500 persons. ****A licence is not required for performance of dance providing it takes place between 08.00hrs-23.00hrs and the audience do not exceed 500 persons.	
Films, Supply of Alcohol Monday-Sunday:09.00 - 00.30	
Oriau agor y fangre/ The opening hours of the premises Monday-Sunday:09.00 - 01.00	
Lle mae'r drwydded yn awdurdodi cyflenwadau alcohol, a yw'r rhain yn gyflenwadau yn y fangre a/neu i ffwrdd o'r fangre / Where the licence authorises supplies of alcohol whether these are on and/or off supplies: Alcohol-On the premises, Alcohol-Off the premises	
Enw, cyfeiriad (cofrestredig) deiliad trwydded mangre / Name, (registered) address of holder of premises licence: Pelham Hall Management Committee, Pelham Hall, Moorcroft Road, Penallt, Monmouth, NP25 4AH	
Rhif cofrestredig y deiliad, er enghraifft rif cwmni, rhif elusen (lle'n berthnasol) Registered number of holder, for example company number, charity number (where applicable): Registered Charity 524369	
Enw goruchwyliwr mangre ddynodedig lle mae trwydded y fangre yn awdurdodi cyflenwi alcohol / Name of designated premises supervisor where the premises licence authorises for the supply of alcohol: Not Applicable – Dissapplication of Mandatory Condition issued 04/03/2016	
Nodwch os yw mynediad plant i'r fangre wedi ei gyfyngu neu ei wahardd / State whether access to the premises by children is restricted or prohibited: Children under 16yrs will only be allowed in the bar area when accompanied by a parent/guardian or adult acting in loco parentis.	